

Family

Backtracking

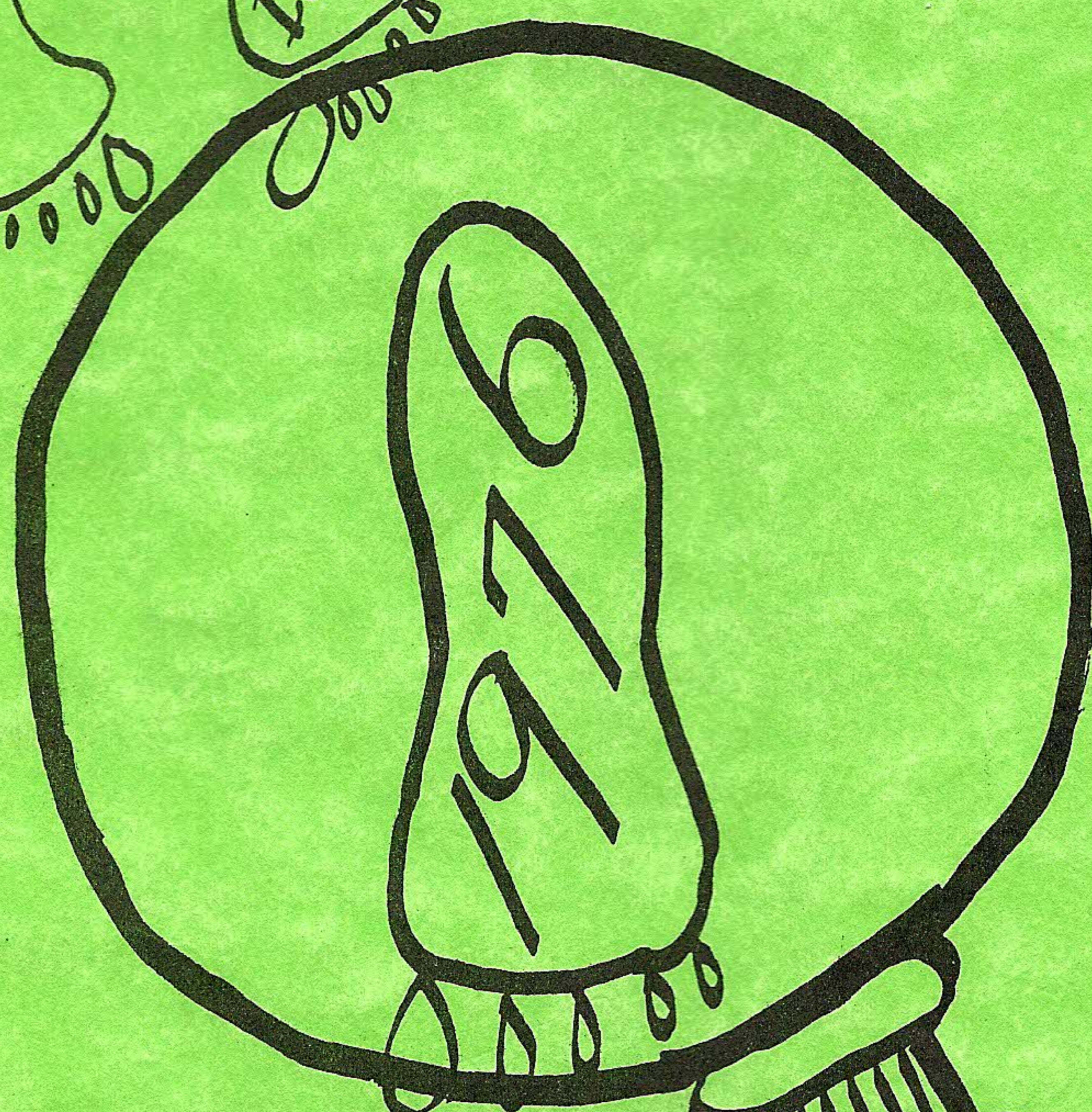

Olympic Genealogical Society

~~Rt. 5 Box 747-F~~

Bremerton, Wa.

1860 Census  
A. B. Allen



OLYMPIC GENEALOGICAL SOCIETY  
Route 5, Box 747 F 4430 PINE AVE. NE  
Bremerton WA 98310

Organized 1974  
Dues: \$6/year or  
\$8 family

OFFICERS, BOARD, COMMITTEES for 1977

OFFICERS:

|                      |                                     |          |
|----------------------|-------------------------------------|----------|
| President .....      | Mrs. Donna Jean Bruce               | 779-3665 |
|                      | 127 Ryen Street, Poulsbo WA 98370   |          |
| Vice-President ..... | Mrs. Sharon Raney Streitt           | 377-1486 |
|                      | 4110 E Street, Bremerton WA 98310   |          |
| Secretary .....      | Mrs. Roseann Mitchell               | 779-4247 |
|                      | 119 Ryen Street, Poulsbo WA 98370   |          |
| Treasurer .....      | Mrs. Carol Neumann                  | 692-9577 |
|                      | 9710 Kitsap Way, Bremerton WA 98310 |          |

BOARD OF DIRECTORS:

|                            |                             |
|----------------------------|-----------------------------|
| Mrs. Marlys Marrs 373-6945 | Mr. Tony Kienzle MY 2-2978  |
| Mr. Jim Hanf ES 3-8376     | Dr. Frederick Drew 377-8561 |
| Mr. Robert Brown ES 7-5980 |                             |

COMMITTEES:

|                           |                                     |
|---------------------------|-------------------------------------|
| Nominating.....           | Board of Directors                  |
| Educational .....         | Sharon Streitt, Chairman 377-1486   |
|                           | Beverly Greene 871-1006             |
|                           | Jane Lagergren 871-1909             |
| Publicity .....           | Doug Lince 479-3338                 |
| Membership .....          | Marlys Marrs 373-6945               |
| Ways and Means .....      | Naomi Morris 377-4982               |
|                           | Betty Ekman 692-8783                |
|                           | Marie Barth 479-2962                |
| Budget .....              | Carol Neumann, Chairman 692-9577    |
|                           | DJ Bruce 779-4247                   |
|                           | Jim Hanf ES 3-8376                  |
| Hostess .....             | Rose Mary O'Brien 377-9306          |
| Librarian & Books .....   | Dorothy Martell, Librarian 697-1634 |
|                           | Frederick Drew, Chairman 377-8561   |
|                           | Bob Brown ES 7-5980                 |
|                           | Jim Hanf ES 3-8376                  |
| Help Letter .....         | Rose Mary O'Brien 377-9306          |
| Historian .....           | Florentine Schonberger ES 3-5894    |
| Bulletin Editor .....     | Roseann Mitchell 779-4247           |
| Bulletin Columns:         |                                     |
| Book Reviews .....        | Sharon Raney Streitt 377-1486       |
| Different From Nowadays.. | Mark Hester 377-1512                |
| Military .....            | Elenora Ball 377-6080               |
| Pedigrees .....           | Nadine Rowan 373-0991               |

BULLETIN DEADLINES for 1977:

January 13, April 14, July 14, October 13.

Articles submitted are not checked for accuracy; therefore, please notify the Editor of any corrections. If articles are typed, please leave at least ten typing spaces for both margins.

Address all questions about FAMILY BACKTRACKING to the Editor, Mrs. Roseann Mitchell, 119 Ryen St., Poulsbo WA 98370. Please enclose SASE.



F A M I L Y    B A C K T R A C K I N G  
Kitsap County, Washington

Quarterly

VOLUME II, No. 3

August 1977

TABLE OF CONTENTS

|   |         |
|---|---------|
| Meeting Schedule . . . . .                                  | page 41 |
| And More Members . . . . .                                  | 42      |
| Library Room . . . . .                                      | 42      |
| Club Corner . . . . .                                       | 43      |
| Kitsap County Cemeteries . . . . .                          | 43      |
| Book Review by Sharon Raney Streitt . . . . .               | 44      |
| 1860 Kitsap County Census, continued . . . . .              | 45      |
| Different From Nowadays by Mark Hester . . . . .            | 48      |
| Navy Yard Post #110 G.A.R. . . . .                          | 49      |
| Bremerton Churches 1902 . . . . .                           | 49      |
| Port Madison Cemetery Inscriptions by Brian Roberts . . . . | 50      |
| Lewis Funeral Chapel Burials, continued . . . . .           | 56      |
| Members' Surnames by Nadine Rowan . . . . .                 | 59      |

\*\*\*\*\*

MEETING SCHEDULE

Every 2nd Thursday, 7:30 pm in Club Library, 4430 Pine Ave. NE, Brem.  
Library open every 4th Thursday, 7-9:30 pm; other evenings by  
appointment Mrs. Marlys Marrs 373-6945.

No library night in August

8 September  
22 September  
25 September  
13 October  
27 October  
10 November

No library night in August

Business & Workshop "Patriotic & Hereditary Organizations",  
what they are and how to join.  
Library night.  
Problem Solving Seminar, Mr. Arthur Fiske, 11 am at  
Club Library, bring sack lunch. See Club Corner.  
Workshop "North and South Carolina Resources".  
Library night.  
Business, Election of Officers, Annual "Show & Tell  
and Bring a Friend" night.



### AND MORE MEMBERS

We extend a happy welcome to all of these new members, and we hope you will volunteer for some of the committees and projects:

|                            |                                   |          |
|----------------------------|-----------------------------------|----------|
| 83. BEAVER, Margie         | 4435 Pine Ave. NE, Bremerton      | 373-7043 |
| 84. BEHNING, Ruth          | 655 Washington Ave., Bremerton    | 377-7944 |
| 85. BOWSER, Mary A.        | St. Rt. 2, Box 465, Belfair       | 275-2257 |
| 86. BURROWS, Marguerite J. | 1012 Franlin Ave., Bremerton      | 377-2869 |
| 87. COMSTOCK, Fern         | 5959 Watauga Beach Dr. E., P.O.   | 871-1189 |
| 88. CRIPPEN, Maxine        | 1526 N. Lafayette, Bremerton      | 377-2925 |
| 89. CROWE, Howard          | 3761 NE Bahia Vista, Bremerton    | 377-9786 |
| 90. FOWLER, Betty          | 5598 Illahee Rd. NE, Bremerton    | 373-7569 |
| 91. GRAY, Dorothy          | 6249 Old Belfair Hiway, Bremerton | 373-0543 |
| 92. KLEIN, Pamela          | Rt.4, Box 478, Bainbridge Island  | 842-4305 |
| 93. LEE, Phyllis           | 1930 Wyoming, Bremerton           | 373-5408 |
| 94. WELSH, Kathy A.        | 3860 SW Lake Helena Rd., P.O.     | 876-2699 |

#### Change of address:

|                     |                                    |          |
|---------------------|------------------------------------|----------|
| 24. LAGERGREN, Jane | 6900 E. Springhill Rd., P.O.       | 871-1909 |
| 25. " Virginia      | "                                  | "        |
| 35. MUNRO, Donna    | 366 NW Bucklin Hill Rd., Bremerton | 692-9553 |

#### Zip Codes:

Bainbridge Island 98111, Belfair 98528, Bremerton 98310, Port Orchard 98366, Poulsbo 98370, and Silverdale 98383.

\*\*\*\*\*

### LIBRARY ROOM

PLEASE, PLEASE, PLEASE note that we need a Librarian. Marlys Marrs has done a tremendous job of reorganizing which required many, many hours of work. We owe her our thanks.....now we need someone to keep it in working operation. Our library has developed into an outstanding feature and is very busy. Our membership now totals 94 .....it takes only one evening for things to become "undone". All of us can help by please returning books to their proper places. But most important we need a Librarian....maybe two or three could work together. You would be surprised how much one can learn from this and it can be fun!!

New purchases by our Club and donations by Jim Hanf, Marlys Marrs, Maxine Beaver and Ida Tevault:

1. 1850 New York Census Index (club).
2. The Pioneer (quarterly on Penn.), Vol. I 1976 (I.T.).
3. The Stickney Genealogy from 1869 (M.B.).
4. International "Who's Who" 1970-71 (J.H.).
5. The Annals of America Vol. I 1493-1754.
6. Pennsylvania Area Keys for Cumberland, Greene & Wash. Counties.
7. Genealogical Reader Northeastern U.S. and Canada by Norman E. Wright (M.M.).
8. Ohio Area Key by C.W. Flavell & F. Clint (M.M.).
9. Genealogical Register of Plymouth Families by W.T. Davis (M.M.).
10. Marriage Records in Iowa of Chickasaw, Dickinson, Story and Webster Counties (M.M.).



## CLUB CORNER

### Mormon Branch Library

The day we have all be waiting for has arrived!!! As announced at our July meeting, the Mormon Branch Library at 2225 Perry Avenue, in Bremerton, is now in operation. Hours are 1-9 pm Tuesday, Thursday and Friday and 9am-5 pm on Saturday. It is suggested you use the South entrance and to call before going to make sure there is a Librarian on duty. (Chapel 479-9370)

### Problem Solving Seminars

At the beginning of the year we were informed that problem solving seminars had been arranged with Mr. Genealogy (Arthur Fiske of Seattle). The response has been most disappointing. If the turnout does not improve we will have to postpone this arrangement. The next one scheduled is for September 25.

For all of our many new members, these seminars work such: We have a roundtable setup, each person explains his problem to Mr. Fiske (he suggests you have at least a pedigree chart available). He will give you a list of resources to check and at the next session (usually two months later) you bring back your results. At this time Mr. Fiske will make further suggestions. This service is just \$10 for two sessions; a big bargain for 30 years experience.

### Cemetery Transcribing and Courthouse Extracting

Our Chairman Marlys Marrs is busy organizing this committee and plotting the cemeteries in our county on a map. She would greatly appreciate volunteers to be in charge of the various areas: the North End, Central, Bremerton, South and Poulsbo. These people would be responsible for finding members to copy the cemeteries in their area.

Also needed are volunteers to tackle the courthouse; possibly one for the births, deaths and marriages and another for the land, naturalization, etc. These people would be <sup>in</sup> charge of getting work parties organized for the extracting.

Would you volunteers please call Marlys Marrs after 6 pm at 373-6945. For those in the North End, you may call Roseann Mitchell at 779-4247. THANKS!!

\*\*\*\*\*

### KITSAP COUNTY CEMETERIES

A few cemeteries in our county have already been done; a couple have been published in our FAMILY BACKTRACKING. The Tacoma Genealogical Society Bulletin has published four cemeteries in our county. We have copies of these in our Club Library and will gladly check for a SASE; we won't duplicate these in our bulletin.

1. Breidablek, Evergreen Cemetery, located 3 miles north on Hiway 3 from Poulsbo. Copied by Mrs. Clifford Aarness, Mrs. Robert Theel, and Mrs. Richard Gustin in 1970.
2. Burley Cemetery, located in the extreme south part of our county, about  $\frac{1}{2}$  mile north of the Pierce Co. line. Donated by Graecia Britten.
3. Seabeck Cemetery, located near Bremerton. Transcribed by Mr. Fred Just.
4. Tracyton Cemetery, located about 1 mile from Tracyton on the left side of the Fairgrounds Road. Copied by Mrs. Clifford Aarness and Mrs. Richard Gustin in 1970.



## BOOK REVIEW

### New at the Olympic Genealogical Society Library:

PENNSYLVANIA AREA KEY--This publication is a genealogical record source book for the state of Pennsylvania. It contains history, maps, charts and a guide to such genealogical subjects and records as: boundary disputes and settlements, land records, nationality and church records, census records and indexes, tax and assessment records, wars and military records, main research facilities and professional researchers, important publications, records and services of the Salt Lake Genealogical Library. Compiled by Florence Clint and published by Everton Publishers, Logan, Utah.

NEW YORK 1850 FEDERAL CENSUS--Accelerated Indexing Systems. This is another addition to our growing collection of census indexes. This 2-volume set indexes the 1850 Federal Census of New York State, exclusive of New York City. It is alphabetized by heads of household and lists county of residence and page number of the original document with each entry. It also contains some helpful research tips and historical maps. Over 750,000 names are indexed in the two volumes!

### Recent arrivals at the Seattle Public Library:

Maryland 1820 Census Index (R929.3752 J136M)  
New Jersey 1830 Census (R929.3749 J 136Nt)  
Indiana 1830 Census Index (R929.3772 J136i)  
Missouri 1840 Census Index (R929.3778 J136M)  
Alabama 1850 Census Index (R929.3761 J136A)  
Arkansas 1850 Census Index (R929.3767 J136A)

A guide to Foreign Genealogical Research; Maralyn A. Wellauer, comp; a selected bibliography of printed material with addresses. (016.9291 458G2--at Desk).

Daughters of the American Colonists. National Society Lineage Book, NSDAC Bicentennial Ancestor Index. (R929 D26491Lb--on the index table).

Index to Obituary Notices in the Richmond Enquirer from May 9, 1804-1828 and the Richmond Whig from January, 1824-1838. Virginia State Library Pub. (R929.3755 V8197i).

Maryland Marriages, 1634 - 1777. Robert Barnes. (R929.3752 B263M).

Index to Genealogical Swop Column of Yankee Magazine; John C. LaPiana. (R929.10973 L314i -- on the index table).

. . . . . Sharon Raney Streitt

\* \* \*

The farther backward you can look, the farther forward  
you are likely to see.--Winston Churchill



1860 Kitsap County Census, continued from Vol. II, No. 2

|                     |    |   |             |    |
|---------------------|----|---|-------------|----|
| O'BRIEN, John       | 26 | M | Mass.       | 36 |
| " John O.           | 20 | M | Ireland     | 28 |
| OLETTE, Geo.        | 32 | M | Canada      | 25 |
| OLIVER, Timothy     | 19 | M | Mass.       | 36 |
| O'NEIL, Edmund      | 23 | M | N.Y.        | 36 |
| PAGE, G.A.          | 30 | M | Ohio        | 25 |
| PARDEL, A.          | 24 | M | Mich.       | 30 |
| PARKER, T.          | 23 | M | Canada      | 30 |
| " Wm.               | 30 | M | Mass.       | 26 |
| PARSONS, Geo.       | 39 | M | Virginia    | 29 |
| " John              | 30 | M | England     | 25 |
| PETERFIELD, Peter   | 42 | M | Germany     | 25 |
| PETERSON, A.        | 27 | M | Mich.       | 37 |
| " Wm.               | 26 | M | Ohio        | 29 |
| PETTINGALL, Saml    | 34 | M | N.H.        | 31 |
| PHILLIPS, Cynis     | 22 | M | Nova Scotia | 37 |
| " E.J.              | 24 | M | "           | "  |
| " Elizabeth         | 23 | F | Penn.       | 25 |
| " Henry             | 20 | M | Maine       | 36 |
| " J.W.              | 30 | M | Penn.       | 25 |
| " Joseph            | 6  | M | "           | "  |
| " W.R.              | 2  | M | Wash. Ter.  | "  |
| PIERCE, Chas.       | 40 | M | Maine       | 36 |
| *PINKHAM, A.        | 30 | M | Iowa        | 31 |
| *" A.S.             | 25 | M | Hanover     | 29 |
| PIERCE, Wm.         | 28 | M | Maine       | 26 |
| PIERPONT, D.L.      | 35 | M | N.Y.        | 33 |
| PORTER, D.H.        | 26 | M | Maine       | 31 |
| " Nath. C.          | 30 | M | Mass.       | 37 |
| PRESCOTT, H.        | 30 | M | Mass.       | 31 |
| " H.                | 30 | M | N.Y.        | 31 |
| PRESTON, A.         | 31 | M | N.Y.        | 30 |
| " C.H.              | 46 | M | Maine       | 31 |
| " Fran              | 26 | M | "           | "  |
| " Geo.              | 36 | M | "           | "  |
| PRIMROSE, Jane      | 20 | F | England     | 29 |
| " P.J.              | 32 | M | Maine       | 29 |
| PRATT, L.           | 26 | M | Penn.       | 25 |
| *PASTERS, F.        | 30 | M | Ohio        | 35 |
| QUIN, S.            | 34 | M | England     | 30 |
| RACE, Frances       | 23 | F | Australia   | 38 |
| " H.                | 26 | M | "           | "  |
| " Harry M.          | 2  | M | Wash. Ter.  | "  |
| RENTON, Mrs. S.M,   | 41 | F | Penn.       | 25 |
| " Wm.               | 44 | M | "           | "  |
| REYNOLDS, L.        | 27 | M | Ireland     | 31 |
| RICHARDSON, Thos.   | 27 | M | England     | 32 |
| RICHMOND, Mary L.W. | 16 | F | Maine       | 37 |
| RIDDELL, Wm.        | 40 | M | P.A.        | 38 |
| RIDGE, Wm.          | 25 | M | England     | 37 |
| RIMES, Chas. A.     | 25 | M | Maine       | 38 |
| " Walter B.         | 23 | M | "           | "  |
| ROB INS, J.M.       | 24 | M | Maine       | 36 |



|                    |    |   |          |    |
|--------------------|----|---|----------|----|
| ROBINSON, Wm.      | 24 | M | Maryland | 27 |
| RODNEY, J.C.       | 21 | M | Vermont  | 28 |
| ROGERS, J.         | 32 | M | Maine    | 38 |
| ROSKUM, A.         | 40 | M | Norway   | 29 |
| ROSS, David C.     | 47 | M | Maine    | 29 |
| ROWAN, Wm.         | 37 | M | Ohio     | 32 |
| ROWELL, A.         | 32 | M | Maine    | 38 |
| ROWLAND, H.        | 28 | M | Maine    | 31 |
| RUSE, Wm.          | 28 | M | Maine    | 36 |
| RYAN, James        | 31 | M | Maine    | 38 |
| " Matthew          | 30 | M | Ireland  | 34 |
| RYANS, John R.     | 19 | M | Maine    | 35 |
|                    |    |   |          |    |
| SACKETT, Wm.       | 38 | M | N.Y.     | 27 |
| SACKMAN, D.        | 39 | M | Maine    | 25 |
| SACKPOOLE, Wm.     | 24 | M | "        | "  |
| SAYWOOD, Thos.     | 24 | M | England  | 28 |
| SCHANRTZA, Wm.     | 29 | M | Prussia  | 32 |
| SCOTT, James       | 38 | M | Virginia | 29 |
| SEAMAN, Wm.        | 31 | M | Maine    | 29 |
| SEARER, J.         | 25 | M | Norway   | 31 |
| SEAVY, Albert L.   | 30 | M | Maine    | 36 |
| " Chas. E.         | 25 | M | "        | "  |
| SELBY, Thomas      | 24 | M | England  | 36 |
| SELKIRK, John      | 28 | M | Mich.    | 26 |
| SHARK, T.          | 31 | M | Germany  | 25 |
| SHEARS, John       | 35 | M | Mass.    | 26 |
| SHORT, John        | 24 | M | Penn.    | 25 |
| SIGO, Jacob        | 31 | M | Holland  | 25 |
| SIMMONS, S.B.      | 43 | M | N.Y.     | 30 |
| SIMMONSON, C.L.    | 29 | M | N.H.     | 25 |
| SKIFF, Willis      | 22 | M | Mass.    | 35 |
| SLATER, F.         | 23 | M | Cal.     | 28 |
| SMITH, Edw.        | 26 | M | Germany  | 27 |
| " J.C.             | 44 | M | N.Y.     | 35 |
| " John             | 23 | M | Germany  | 26 |
| " Thos. C.         | 38 | M | Maine    | 35 |
| SNYDER, G.C.       | 34 | M | Tenn.    | 28 |
| SPAULDING, H.      | 30 | M | N.Y.     | 29 |
| " Mary             | 27 | F | England  | 29 |
| " Wm. A.           | 4  | M | "        | "  |
| " Wm. C.           | 30 | M | "        | "  |
| ST. LOUISE, Peter  | 37 | M | Canada   | 25 |
| STEPHEN, Winslow   | 39 | M | Maine    | 36 |
| STEPHENSON, Benj.  | 33 | M | Maine    | 37 |
| " R.               | 21 | M | "        | "  |
| " S.               | 56 | M | Canada   | 32 |
| *STONE, D.G.       | 30 | M | Maine    | 34 |
| " B.R.             | 27 | M | Conn.    | 30 |
| " Cyrus            | 24 | M | Mass.    | 39 |
| STRONG, Ward       | 26 | M | Ireland  | 27 |
| SUMMER, J.M.       | 26 | M | Maine    | 31 |
| SUTHERLAND, Joseph | 59 | M | Ky.      | 32 |
| SWEAT, A.J.        | 52 | M | N.Y.     | 38 |
|                    |    |   |          |    |
| TAY LOR, B.S.      | 37 | M | Ohio     | 27 |
| " John             | 33 | M | Scotland | 30 |



|                  |    |    |               |    |
|------------------|----|----|---------------|----|
| TETURR, A.       | 35 | M  | Virginia      | 32 |
| THACBERG, John   | 30 | M  | Canada        | 31 |
| THOMAS, J.F.     | 24 | M  | N.Y.          | 30 |
| THOMPkins, John  | 32 | M  | Mass.         | 36 |
| THOMPSON, C.     | 26 | M  | Sweden        | 30 |
| " E.H.           | 26 | M  | Ohio          | 25 |
| " G.S.           | 34 | M  | New Brunswick | 27 |
| " H.             | 30 | M  | Sweden        | 30 |
| " James          | 40 | M  | N.Y.          | 38 |
| " John           | 36 | M  | England       | 27 |
| " Peter          | 41 | M  | Germany       | 26 |
| THORAF, John     | 26 | M  | Denmark       | 32 |
| THORNDYKE, C.U.  | 26 | M  | Maine         | 27 |
| TIBBETTS, W.M.   | 35 | M  | Maine         | 37 |
| TRIPP, F.        | 26 | M  | Conn.         | 27 |
| TUINEY, C.W.     | 21 | M  | Maine         | 35 |
| TULLIS, J.D.     | 26 | M  | Maine         | 37 |
| TURNER, Benj.    | 21 | M  | Maine         | 35 |
| " James          | 23 | M  | Australia     | 38 |
| TUTTLE, A.L.     | 36 | M  | Penn.         | 28 |
| VINCENT, Lewis   | 40 | M  | Mass.         | 25 |
| WALKER, Cyrus    | 32 | M  | Maine         | 34 |
| WALLACE, J.M.    | 28 | M  | "             | 32 |
| WARD, W.T.       | 36 | M  | "             | 38 |
| WATERMAN, Delas  | 32 | M  | N.Y.          | 27 |
| WEBBER, John     | 25 | M  | Maine         | 27 |
| WEBSTER, John    | 46 | M  | N.Y.          | 27 |
| WEED, Phillip    | 22 | M  | Maine         | 29 |
| WEEKS, F.L.      | 29 | M  | N.H.          | 30 |
| WELCH, David     | 21 | M  | Mass.         | 27 |
| WEST, George     | 27 | M  | Germany       | 35 |
| WESTON, Olive    | 39 | F  | Maine         | 34 |
| WHITE, A.K.      | 35 | M  | Mass.         | 36 |
| " James          | 24 | M  | Maine         | 37 |
| " John           | 26 | M  | Mass.         | 28 |
| " Louis          | 23 | M  | Maine         | 36 |
| " Robt.          | 30 | M  | Canada        | 37 |
| WILLIAMS, A.B.   | 24 | M  | Maine         | 38 |
| " J.C.           | 32 | M  | N.Y.          | 28 |
| " James E.       | 30 | M  | Mass.         | 26 |
| " Thos.          | 30 | M  | Mass.         | 28 |
| WILLIAMSON, J.L. | 29 | M  | Maine         | 36 |
| " J.R.           | 30 | M  | N.Y.          | 33 |
| " Julia          | 27 | F  | Ireland       | 33 |
| " Wm.            | 1  | M  | Wash. Ter.    | 33 |
| WILSON, Anna     | 4  | F  | "             | 34 |
| " Geo.           | 35 | M  | Mass          | 37 |
| " Henry C.       | 34 | M  | Maine         | 34 |
| " Mary R.        | 24 | F. | "             | "  |
| " Otis           | 59 | M  | Maine         | 37 |
| " S.B.           | 27 | M  | "             | 34 |
| " Sarah S.       | 58 | F  | Mass.         | 37 |
| " Susan R.       | 26 | F  | Maine         | 34 |
| " Thos.          | 26 | M  | N.Y.          | 37 |



|                |       |   |         |    |
|----------------|-------|---|---------|----|
| WINBORN, Robt. | 27    | M | England | 33 |
| WINGATE, R.R.  | 32    | M | Maine   | 39 |
| WINN, John     | 28    | M | Penn.   | 30 |
| WOODBURY, W.   | 30    | M | Mass.   | 30 |
| WOODS, J.W.    | 33(B) | M | N.J.    | 25 |
| WRIGHT, L.C.   | 45    | M | Germany | 26 |
| " W.W.         | 35    | M | Wisc.   | 30 |
| YOUNG, A.B.    | 37    | M | Maine   | 33 |
| " Frederick A. | 9     | M | "       | "  |
| " Horace H.    | 6     | M | "       | "  |
| " Hulda        | 35    | F | "       | "  |

\* Out of sequence

TOTALS: 478 males, 66 females.

\* \* \* \* \*

### DIFFERENT FROM NOWADAYS

by Mark Hester

### SURNAMES

The period following the Norman Conquest of England in 1066 was marked by another innovation, the adoption of the use of surnames. The development of surnames was a practical necessity. With the widening of interests, from interests involving only a local community to interests involving a whole country, and in our own day, to a considerable extent, the whole world, new means of distinguishing names have become more and more indispensable.

The first source of surnames are suffixes. Among the Scandinavian peoples the suffix is - son, Olson (Olaf & son), Anderson (Andrew's son). Among the Scotch and Irish it is - mac, MacDonald. Among the English it is - fitz, like in Fitzgerald, or Fitzsimmons, meaning the son's of.

The second source of surnames is from the country or locality with which a man is associated. Scott is said to be an English name applied to a Scotchman. Champneys is a name applied to a native of Champagne. Other names of this kind are Brett-Britton (native of Brittany), Picard-Power (Picardy), Loring (Lorraine), Bullen (Boulogne), Blass (Blois), Loving (Lou Vain), Sessions (Soissons), Turney (Tournay).

A third principle source of modern surnames is to be found in names of occupation. The number of names from this source is even greater than appears at first sight. There are Smith, Butcher, Carpenter, Miller, Taylor and their like, now applied utterly without relation to occupation, but forming the most widely used type of surname.

A fourth general source of surnames is to be found in nicknames. The word nickname itself, from earlier "an eke name" originally being the equivalent of surname. Features of dress are expressed by Capron (hood), Burden (staff), Motley (fool's costume).

Many of the names of Celtic origin are interesting because the original meaning is so completely lost sight of, as in the Welsh Gough and Roe, both meaning "red", Bain, Wynne and Gwyne all meaning "white", Glass, Lloyd and Floyd meaning "gray", Sayee is "Saxon", and the Irish Kennedy is "Ugly Head". In many cases the foreign name is translated Schumacher-Shoemaker; Neuman-Newman, Schuartz-Black.

Surely the ends of the earth are brought together in the words that form the American surnames.

English Words and Their Background by George H. McKnight, Ph.D



NAVY YARD POST #110 G.A.R.

The Grand Army of the Republic (G.A.R.) was an American patriotic organization, consisting of United States armed forces veterans of the Civil War. The G.A.R. admitted any member of the United States Army, Navy, or Marine Corps who had served between April 12, 1861, and April 9, 1865, and had been honorably discharged, and also members of State regiments who had been called into service. The organization was founded for the commemoration of dead comrades and the practice of fraternity and mutual assistance. The organization was responsible for passage of the Disability Act of 1890, which doubled the pension roll; it also established old soldiers' homes, and provided care and education for soldiers' orphans.

On March 23, 1902, a meeting was held in Bremerton for the purpose of organizing a local chapter of the G.A.R. The following Civil War veterans were present: W. J. Galbraith, A. D. Hartman, J. R. Bell, J. H. Nibbe, Warren Smith, F. E. Denzel, B. F. Whitaker, M. R. Brewster, G. W. Sutton, A. W. Peterson, Thomas Buckley, T. F. Mahan, Phil. A. Wood, Charles Anderson, M. Coltenbaugh, Chas. Draper, Cyrus Thomas, C. D. Benson, M. McFarland, and M. V. Hartwell.

On March 30, 1902, a second organizational meeting was held and the following veterans were added to the roll: A. W. Stiles, H. R. Gale, H. Brintnell, A. F. Haynes and M. E. Johnson.

The first officers of Navy Yard Post #110, G.A.R. were:

Post Commander -- H. R. Gale  
Sr. Vice Com. -- W. J. Galbraith  
Jr. Vice Com. -- M. R. Brewster  
Officer of the Day -- J. R. Bell  
Quartermaster -- Charles Draper  
Chaplain -- A. F. Haynes  
Surgeon -- J. H. Nibbe  
Adjutant -- T. F. Mahan  
Officer of the Guard -- M. E. Johnson

The organization of the post was completed on April 3, 1902, with the installation of the officers.

. . . Sharon Raney Streitt

\* \* \*

BREMERTON CHURCHES 1902

|   |   |
|---|---|
| German Lutheran -- W. Knappe Pastor                         | Methodist Episcopal -- G. Arney, Pastor             |
| Our Lady Star of the Sea Catholic -- Rev. M. J. Woods, S.J. |   |
| United Norwegian Lutheran -- Rev. Jerde, Pastor             |   |
| Christian Science   | Episcopal -- Rev. Buzzelle, Pastor                  |
| Epworth League -- F. W. Coder, Pres.                        | Port Orchard Presbyterian -- A.J. Whipkey -- Pastor |



## PORT MADISON CEMETERY INSCRIPTIONS

transcribed by Brian Roberts, February 1977

Kane Cemetery at Port Madison is the oldest cemetery on Bainbridge Island. The oldest stone is dated 1867, and there are a number of unmarked graves that could be even older. Although the property is owned by the Free and Accepted Masons, it is a resting place for people of many different associations, religions, and races. The manager is Robert B. Ross of 9638 N.E. Lafayette, Port Madison, a member of the Kitsap County Historical Society who knows a great deal about island history. Several generations of Mr. Ross's own ancestors are buried in the cemetery.

On the next page is a diagram of the cemetery, excluding the part that has not yet been used. The rows and columns are labeled to help in finding the approximate physical location of the stones listed alphabetically below. U3, for instance, means that a grave is in column U, row 3, in the northeast part of the map area.

Stones are listed here by name and dates. Where a stone has additional wording that might be of genealogical value, this is included in parentheses.

ABUEHL, Marie, 1882-1970 (mother) Q51  
ADAMS, Jane, 1922-1968 S44  
ADAMS, Margaret L., May 23, 1879 - June 16, 1884 (daughter of Lester P. & Rettie Adams) E25  
AGER, Bess E., 1895-1976 T49  
AGER, Lee Harold, 1893-1957 (Masonic symbol) T50 (same stone)  
ALMAZAN, Adelina Engarcia, Sept. 8, 1946 - Mar. 8, 1947 08  
ALMIROL, Domingo P, May 9 1909 - Jan 8 1971 (Washington, PFC, 1 Filipino Inf Regt, World War II)(Christian cross) R18  
ALMIROL, John A., 1961 R22  
ALMOJUELA, Graciano Jr., 1950-1951 P9  
ALPAUGH, Robert S, May 21 1921 - Dec 8 1971 (Washington, RM2, US Navy, World War II)(Christian cross) R53  
ANDERSEN, Capt. Amund, 1867-1931 G55 (same family plot as Paul E. Jorgensen)  
ANDERSEN, Anna J., 1874-1957 G56 (same family plot)  
ANDERSON, Andrew G., Jan. 22, 1858 - Jan. 10, 1927 F53  
ANDERSON, Annie, 1876-1965 C43  
ANDERSON, August, 1865-1957 C42 (same stone)  
ANDERSON, Ellen, 1874-1922 F7  
ANDERSON, Elsie, 1906-1938 (beloved sister) K8  
ANDERSON, Louise, Apr. 10, 1911 aged 63 yrs. (wife of Paul Anderson, native of Norway, died at Manitou Beach) I41  
ANDERSON, Paul, 1858-1932 E8  
ANDERSON, Selma C., Dec. 9, 1870 - July 8, 1929 F54 (same stone as Andrew G.)  
ANNER, Capt Albert, 1869-1907 C41  
ANNER, Allen W., age 38 yrs. C42  
ANNER, Fred, May 30, 1869 - Sept. 8, 1896 (born in Sweden, died at Port Madison) C36  
ANTRIM, Ruth A., 1884-1976 (mother) J14  
ARANEDA, Mindy S., 1935-1974 T51  
ARCAND, Paul Francis, 1958-1976 (Christian cross) T49  
ARMSTRONG, James E., March 9 1933 - Jan 6 1974 (Mich., S Sgt, US Air Force, Korea) T23  
ARNOT, Elizabeth L., Nov. 20 1915, age 58 yrs (mother) H10



Pt. Madison Cemetery (Cont.)

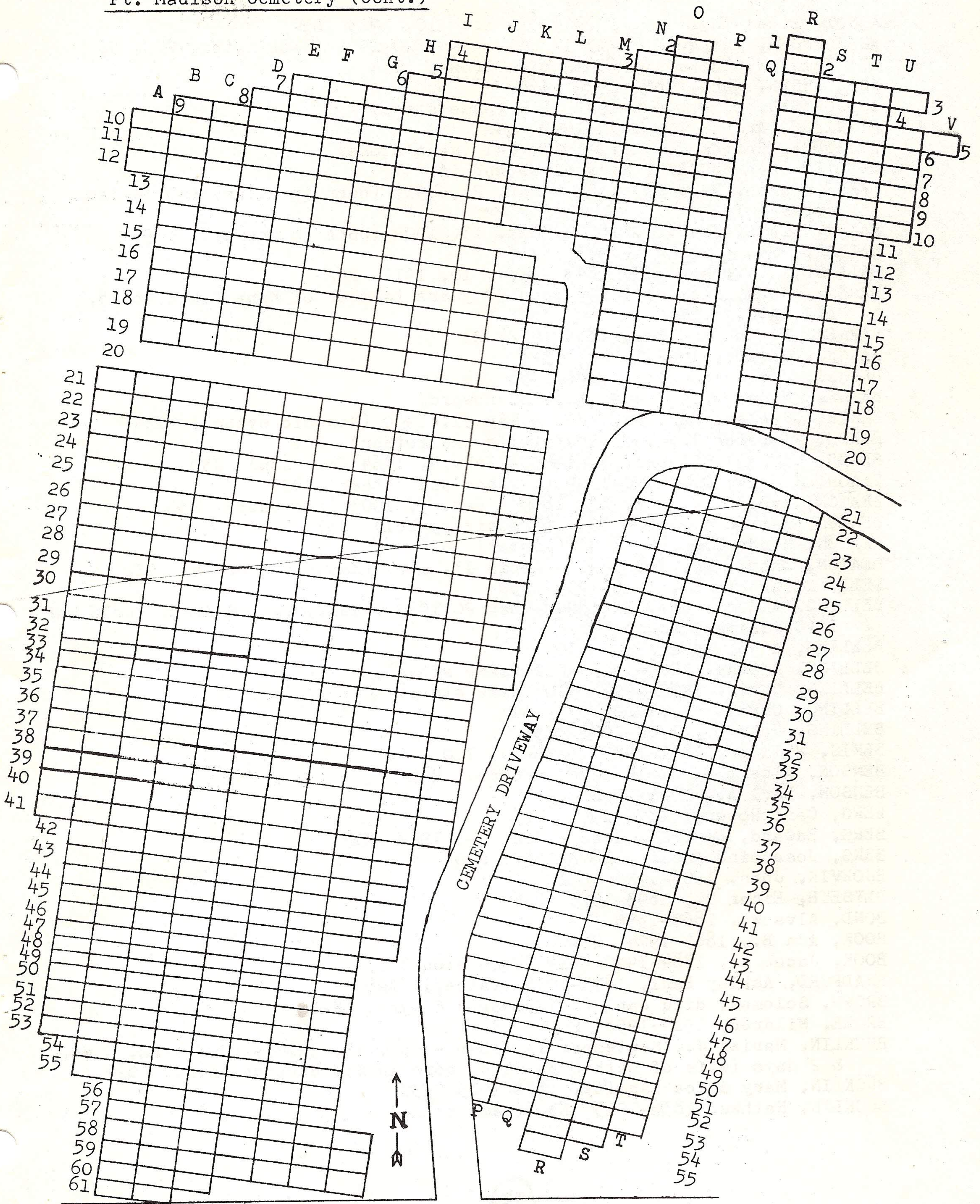

N.E. LAFAYETTE STREET



Pt. Madison Cemetery (Cont.)

ARNOT, Ethel May, Oct. 19, 1923 - Nov. 10, 1923 A10  
ASBJORSEN, Andrew M, July 17 1913 - May 20 1972 (Washington, PFC, US  
Army, World War II)(Christian cross) T14  
ASBJORSEN, Jens, 1872-1939 E59  
ASBJORSEN, Olga, 1875-1942 E60 (same stone)  
ATTRIDGE, Arthur W., 1877-1947 Q42  
ATTRIDGE, Bertha E., 1877-1961 Q41 (same stone)  
BABBITT--see BUCKLIN, Mary Alice Babbitt  
BAKKE, Jakob, Aug. 29, 1870 - Mar. 25, 1917 (born in Norway)(Christian  
cross) I46  
BAKKE, Ole E., Mar. 1, 1857 - Oct. 13, 1902 (born in Norway) C29  
BALLARD, Mary C., 1854-1933 F41  
BALLARD, W.N., Mar. 23, 1843 - Nov. 10, 1911 F42  
BARKER, John, Dec. 4, 1869, aged 30 years (member of Kane Lodge No. 8,  
A.F.&A.M.) H18  
BARNES, Bertha Aneline, 1889-1972 R3  
BARNES, Howard, 1902-1974 T13  
BARNES, James Franklin, 1886-1958 R4  
BARNES, Naomi T12 (same stone as Howard)  
BARTELS, Peter, Mar. 22, 1832 - May 31, 1909 (Masonic symbol) I34  
BEACH, Florence V., 1901-1973 (wife and mother) R21  
BEACH, Michael C., Dec. 3, 1963 - Feb. 8, 1964 (our son) J39  
BEACH, Stanley C., 1890-1969 (husband and father) R21  
BEATON, Evelyn F., Nov. 17, 1899 - Jan. 9, 1903 (our baby) G30  
BEATON, Hattie A., 1860-1926 (Masonic symbol) G31  
BEATON, Maude L., 1885-1950 (sister) G29  
BEATON, Thos., May 15, 1841 - April 13, 1907 (Masonic symbols) G32  
BELL, Elizabeth E., 1916-1939 I50  
BELLING, Anders, Oct. 12 1894 - May 20 1969 (Wash., Pvt US Army, World War  
I)(Christian cross) T21  
BELLING, Anne, 1872-1960 G10  
BELLING, Bjarne, 1909-1913 G10 (same stone)  
BELLING, Chris, 1872-1927 G10 (same stone)  
BELLING, Christine, 1908-1973 G11  
BELLING, John C., 1906-1973 S3  
BEMIS, Wallace, 1861-1935 (father) I10  
BENSON, Albert E., 1916-1968 (anchor) R47  
BENSON, Earl A., 1909-1976 U6  
BERG, Carl Robert, 1876-1966 P26  
BERG, Edward, Dec. 21, 1866 - Jan. 24, 1942 M13  
BERG, Josephine Amelia, 1872-1957 P25  
BJORVIK, John, 1906-1925 D11  
BLYSETH, Einar O., 1893-1975 P36  
BOND, Alva W., 1865-1956 B44  
BOOK, Ada B., 1885-1974 H24  
BOOK, Jacob E., 1884-1970 H24 (same stone)  
BRADFORD, Ashley Earl, 1875-1938 (father) E26  
BROWN, Solomon, died Jan. 6, 1890 aged 67 yrs. K27  
BROZE, Mildred, 1914-1958 P23  
BUCKLIN, Marian S., September 11, 1846 - Oct. 13, 1874 aged 28 yrs, 1 mo.  
& 2 days (wife of Nathan Bucklin, born in St. Stephen, N.B.) G22  
BUCKLIN, Mary Alice Babbitt, 1849-1915 E30  
BUCKLIN, Nathan, 1839-1915 E30 (same stone)



Pt. Madison Cemetery (Cont.)

BULL, William, March 19, 1850 - March 10, 1905 (Here rests a Woodman of the World.) D26  
BURK, Alvin H., 1894-1966 R45  
BURK, Ovina O., 1900-1967 R44 (same stone)  
BURNS, Marian L., 1909-1957 D45  
BURROWS, C.D. "Chuck", 1910-1968 ("my honey")(Winslow Police badge #3) Q50  
BUTTERFIELD, Josephine, 1865-1906 (mother) H16  
CADDICK, Beatrice, 1881-1973 (Christian cross) P45  
CADDICK, Ernest J., 1895-1973 (Christian cross) P46 (same stone)  
CALLAHAM, Allan B., May 2, 1938 - Oct. 23, 1938 B12  
CAMPBELL, Colin Stuart, March 27, 1840 - April 17, 1883 (born St. Stephen, N.B. Canada, died Seattle Wash. Ter., erected by his mother) G26  
CAPELL, Lillie Sorensen, 1908-1937 C53  
CAREY, Alfred J, Jan 24 1911 - March 30 1974 (Massachusetts, Maj US Army Res, World War II, Korea)(Christian cross) S54  
CARLSON, Alfred, 1856-1933 E10  
CARLSON, Lars Mathias DeWet, July 10, 1900 - August 24, 1975 (born Hibbing, Minnesota, died Seattle, Washington, Pvt, US Army, World War I, "A Gentleman")(Christian cross) U3  
CARLSON, Swan M., 1866-1911 I37  
CAVE, Clinton Robert, 1902-1970 N19  
CAVE, Lillian G., Mar. 22, 1864 - Aug. 28, 1965 L5  
CAVE, Robert A., 1864-1939 L6  
CESSNA, George Elmer, 1879-1948 B15  
CESSNA, Ida Winifred, 1887-1948 B14 (same stone)  
CHASE, Annie Selfors, 1866-1949 B35  
CHESTER, David L., 1927-1941 N17  
CHITTENDEN, Hiram M., 1894-1971 S14  
CHRISTOFFERSEN, Mr. and Mrs. F58, F59  
CICERO, George Henry, 1874-1953 P6  
CICERO, Lillian Althea, 1880-1972 P5 (same stone)  
CLAMPETT, Arthur W., 1884-1941 I6  
CLAMPETT, Emma Jane, 1864-1947 I4  
CLAMPETT, William E., 1863-1935 I5 (same stone)  
CLEMENT, Charles T., 1898-1958 R6  
CLIFTON, Gifford, 1902-1974 I17  
COHEN, Marguerite Quitslund, 1912-1961 (musical notation showing 4-note bar from Beethoven's Fifth) K16  
COHEN, Merilyn--see COPPOCK, Merilyn Cohen  
COMSTOCK, Margaret, died Oct. 28, 1881, aged 44 years (wife of Jos. Comstock) D19  
CONNER--see GROW, Susan Conner  
COOK, Chesley W., 1882-1965 (Christian cross) P39  
COOK, Dean J., 1911-1963 P29  
COOK, Mary, 1872-1964 (Christian cross) P38  
COOKE, Claude C., Oct. 21, 1881 - Nov. 24, 1945 O14  
COOKE, Mabel Ann, Sept. 12, 1881 - Feb. 26, 1958 P28  
COONE, Mabel O., 1909-1951 M5  
COOPER, Wesley J., 1877-1965 C55  
COPPOCK, Merilyn Cohen, 1942-1976 K16  
CORMODE, Beatrice C., July 2, 1953 K9  
CORMODE, John W., Jan. 16, 1971 K9 (same stone)  
COSSETTE, Darlene Dorothy, Feb. 18, 1936 - June 26, 1956 H35



Pt. Madison Cemetery (Cont.)

COSSETTE, Ernest, 1895-1953 H38  
COX--see NORMAN, Attila Cox  
CRAGERUD C39  
CURTIS, Hazel S. I11  
CURTIS, Irving S., 1895-1945 I12 (same stone)  
DANIELSEN, John A., 1883-1971 (father) T27  
DANZ, Herbert M, Aug 31 1888 - Feb 29 1972 (Washington, SFC 67 Spruce  
Sq, World War I)(Christian cross) D14  
DAUGLES, John L.M., Sept. 9, 1868, aged 23 years (a native of Chatham,  
Canada West, killed by the accidental discharge of a gun, in his own  
hands on Widbey, Island) I18  
DAY, H.A., 1850-1930 E55  
DAY, June I., 1923- E56  
DAY, Vernon W., 1913-1973 (Christian cross) E57 (same stone)  
DeBOLT, Nellie, 2 mos., 1899 H37  
DEHLER, R.R., 1918-1973 R1  
De MUSIE, Florence, 1890-1967 T11  
DENNIE, infant, 1930 C44  
DeSHAW, William, 1834 - Jan. 21, 1900 (operated Agate Pt. trading post) L31  
DESMOND, Jerry E., 1922-1964 S21  
DIRSCHERL--see REIDELL  
DOUGLAS, Alice M., Nov. 20, 1972 (our mother) C13  
DOUGLAS, Alonzo, aged 29 yrs. B36  
DOUGLAS, James, aged 81 yrs. B40 (same stone)  
DOUGLAS, Jennie, aged 52 yrs. B39 (same stone)  
DOUGLAS, Lizzie, aged 16 yrs. B38 (same stone)  
DOUGLAS, William, aged 28 yrs. B37 (same stone)  
DOWELL, Grover C, Jan 5 1887 - Nov. 15 1964 (Washington, Cpl Co K 361 Inf  
91 Div, World War I)(Christian cross) R23  
DUGAN, Larry H., 1911-1968 (shamrock) R29  
EASTBERG, Sivert, 1854-1929 G52  
EASTBERG, Marie, 1866-1930 (his wife) G51 (same stone)  
EKERN, Ellen, 1890-1921 B41  
EKERN, Peder, 1885-1961 R23  
ELDREDGE, Betty M., 1905-1975 I15  
ELEY, Lucy, died May 29, 1880, aged 20 years (wife of Henry Eley) K21  
ELEY, Ruth, died Dec. 12, 1880, aged 2 yrs. 7 months (daughter of  
H. & L. Eley) K21 (same stone)  
ELLINGSEN, Henrik, 1878-1949 L10  
ELLINGSEN, Marie E., 1886-1974 L11  
ELLINGSEN, Victor B., 1915-1935 L12  
ELLIOTT, Katherine L. H50  
ELOFSON, Alice B., May 13, 1885 - Jan. 15, 1959 G24  
ELOFSON, Benjamin S., Sept. 18, 1887 - Sept. 11, 1952 G25  
ELVSAAS, Agnes M., 1906-1956 (mother) R12  
ELVSAAS, Herman M., 1900-1957 (father) R11 (same stone)  
ENGBRETSON, Edward, 1866-1949 G43  
ENGBRETSON, Petra, 1871-1949 G42  
ENGBRETSON, Randi, 1867-1915 G44  
ENGLISH, David, 1830-1916 D43  
ENGSTROM, Alyce E., 1899-1965 P46  
ENGSTROM, Jonas M., 1889-1965 P47 (same stone)



Pt. Madison Cemetery (Cont.)

ERICKSEN, Ethel, June 10, 1918 - June 10, 1919 B12  
ERICKSON, Elizabeth, 1865-1929 (mother)(Christian cross) F55  
ERICKSON, Samuel, 1864-1940 F56  
ERICKSON, William (temporary marker) F57  
EWALD, Frank C., 1884-1975 U7  
FAUBION, John Ross, Mar. 6, 1915 - Mar. 10, 1969 (Christian cross) R43  
FINCH, Jesse T., died April 1, 1889 aged 18 yrs. E40  
FINCH, Jesse W., April 1, 1910 - August 18, 1968 aged 58 years (Greater love  
hath no man that he give up his life for another.) E44  
FINCH, Ora M., died March 15, 1896 aged 22 years E42 (same stone as Jesse T.)  
FINCH, Ora May E39  
FINCH, Susanna, died April 1, 1879, aged 9 Ms. E41 (same stone as Ora M.)  
FINCH, Wm. T., died May 18, 1907 aged 67 years E43 (same stone)  
FOX, Douglas Craig, 1925-1926 P21  
FOX, Irving, 1880-1941 P21  
FOX, Laura C., 1888-1958 P21 (same stone)  
FRED KSON, Ran T., bon 1912 deid 18 13 A12  
FREEMAN, Waldemar Rudolph, geboren den 19, Sept. 1879; gestorben den 22,  
Feb. 1881 E19  
FRENCH, Johnson Louis, 1900-1962 Q33  
FRENCH, Warnie Lee, Aug 15 1915 - June 17 1960 (Washington, Pvt US Marine  
Corps, World War II)(Christian cross) Q30  
FROYEN, Henry S., February 12 1919 - June 18 1944 (Washington, S Sgt 122  
AAF Bomb Sq, World War II)(Christian cross) B29  
FROYEN, Sophie--see LUND, Sophie Froyen  
GARRIOTT, Ambrose Harvey, 1871-1962 R16  
GARRIOTT, Iva Llewellyn, 1884-1955 R17  
GELINEAU, John B., 1872-1948 J59  
GEORGE, Albin B., 1890-1907 C37  
GEORGE, Margaret, Aug. 16, 1860 - Aug. 31, 1936 C38  
GEORGE, William E., Jan. 15, 1892 - Nov. 1, 1956 C39  
GEORGE, William J., 1832-1889 B21  
GERHARDT, Alexander S., born April 8, 1878. died April 10, 1882. (son of  
C.F. & S.C. Gerhardt) F22  
GERHARDT, Frank, 1879-1948 F26  
GERHARDT, Frank K., 1879-1948 F25 (probably same person)  
GERHARDT, Frederick C., born May 25, 1874 died Sept. 26, 1889 F23  
GERHARDT, Lydia, 1885-1969 F26 (same stone as Frank)  
GERHARDT, Mary C., born Jan. 29, 1870, died Jan. 27, 1880. F21  
GERHARDT, baby, born June 18, 1881 died June 20, 1881. (Suffered patiently.  
Children of C.F. & S.C. Gerhardt.) F21 (same stone)  
GERHARDT, Matthies J, born Mar. 19, 1876 died Sept. 9, 1896 F24 (same  
stone as Frederick C.)  
GIBSON, Foster C., 1883-1966 (Masonic symbol) Q21  
GIBSON, Trixy A., 1887-1973 (Order of Eastern Star symbol) Q21  
GILLAM, Ann, 1886-1961 R24  
GJESBAK, Anton John, 1883-1951 P7  
GODOW--see KESSLER  
GOLLER, Karen Louise, Mar. 9 1942 - Mar. 10 1942 T28  
GRANDY, John, born Feb. 17, 1839, died Aug. 24, 1895. (Masonic symbol) E14  
GRAVES, Devalson D., Aug. 4, 1883 - Nov. 27, 1935 J9  
GRAVES, Dorothy E. Martin, 1905-1976 J8 (same family plot)  
GRAVES, Mary Frances, Sept. 17, 1885 - Jan. 6, 1936 J9 (same stone as D.D.)

.....to be continued.....



LEWIS FUNERAL CHAPEL BURIALS Continued

Beginning Vol I, No. 4, 1976

1916

|              |                          |                    |                           |
|--------------|--------------------------|--------------------|---------------------------|
| OK April 26  | Jean E. Schutt           | 1 day              | Ivy Green Cemetery        |
| OK April 27  | Infant Meeks             | Infant             | Ivy Green Cemetery        |
| April 26     | Hattie Thompson          | 48 y. 5 m. 11 d.   | Puyallup, Washington      |
| April 28     | Abe S. Levy              | 42 yrs.            | Victoria, B.C.            |
| OK May 3     | Nelse Lundburg           | 80 y. 11 m. 16 d.  | Charleston Cemetery       |
| May 3        | Oliva Nelson             | 59 y. 8 m. 1 d.    | Seattle, Washington       |
| May 6        | Joseph W.M. Sinclair     | 39 y. 5 m. 20 d.   | Seattle, Washington       |
| OK May 8     | Charles Lund             | 68 yrs.            | Ivy Green Cemetery        |
| May 11       | Vernie Davis             | 44 y. 4 m. 21 d.   | Sedro Woolley, Washington |
| NO May 14    | Lydia Scott              | 57 y. 3 m. 6 d.    | Ivy Green Cemetery        |
| May 25       | Bodner A. Carter         | 31 y. 2 m. 21 d.   | Seattle, Washington       |
| OK May 29    | Mary Wieck               | 39 y. 3 m. 8 d.    | Ivy Green Cemetery        |
| OK May 30    | Thomas S. Fellows        | 48 y. 9 m. 6 d.    | Ivy Green Cemetery        |
| May 31       | Margaret Cooley          | 77 y. 9 m. 20 d.   | Seattle, Washington       |
| OK June 1    | Charles A. Harris        | 89 y. 6 m. 7 d.    | Ivy Green Cemetery        |
| June 6       | Michael Morgan           | 51 y. 1 m. 9 d.    | Chicago, Illinois         |
| OK June 12   | Bertha Harrigan          | 28 y. 9 m. 28 d.   | Ivy green Cemetery        |
| OK June 18   | PERRY J. Baldwin         | 54 y. 10 m. 11 d.  | Ivy Green Cemetery        |
| OK June 19,  | Fred V. HARRIS           | 37 yrs. 10 m. 7 d. | Ivy Green Cemetery        |
| OK June 23   | Samuel H. Berry          | 66 y. 10 m. 15 d.  | Ivy Green Cemetery        |
| June 28      | Mary M. Parkes           | 71 y. 3 m. 7 d.    | Tacoma, Washington        |
| X June 16 ✓  | Robert F. Dixon          | 26 yrs.            | Naval Cemetery            |
| OK July 5    | Infant James             | infant             | Ivy Green Cemetery        |
| OK July 4 ✓  | Vernon D. Burwell        | 29 yrs.            | Naval Cemetery            |
| NO July 9    | Sarah A. Millar          | 80 y. 10 m. 8 d.   | Ivy Green Cemetery        |
| OK July 9    | INFANT Walter Davis, Jr. | infant             | Ivy Green Cemetery        |
| OK July 9    | Floyd Humes              | 28 y. 5 m. 10 d.   | Ivy Green Cemetery        |
| NO July 17   | Evelyn Mixon             | 5 y. 8 m. 29 d.    | Ivy Green Cemetery        |
| OK July 16   | Hause C. Jensen          | 70 yrs.            | Ivy Green Cemetery        |
| July 27      | Ella M. Jones            | 55 y. 7 m. 29 d.   | Seattle, Washington       |
| July 30      | David Hill               | 77 yrs.            | Mukwonga, Wisconsin       |
| August 4     | Elizabeth Asheucut       | 86 y. 2 m.         | Richmond, Wales           |
| NO August 10 | Francis Atcheson         | infant             | Ivy Green Cemetery        |
| NO August 17 | George Hoyt              | infant             | Ivy Green Cemetery        |
| August 18    | Charles West             | 5 days             | Ivy freen Cemetery        |
| NO August 18 | George Heffner           | 58 y. 3 m. 24 d.   | Ivy Green Cemetery        |



LEWIS FUNERAL CHAPEL BURIALS continued

1916

|                  |  |                    |                               |
|------------------|--|--------------------|-------------------------------|
| OK August 21     | Alice T. Hanson                          | 27 yrs. 4 m.       | Ivy Green Cemetery            |
| August 25        | Nora E. Swilie                           | 30 y. 3 m. 3 d.    | Seattle, Washington           |
| NO September 16  | Charles Roberts                          | 10 days            | Ivy Green Cemetery            |
| OK September 16  | Augusta Evert (EVERET)                   | 40 y. 29 d. L      | Ivy Green Cemetery            |
| September 17     | Clarence Lund                            | 14 yrs. 3 m. 10 d. | Seattle, Washington           |
| OK October 2     | Infant Abrahamson (PAUL)                 | infant             | Charleston Cemetery           |
| October 3        | Westley Anthony                          | 40 yrs.            | YES ✓ Brownsville Cemetery    |
| OK October 7     | Frederick J. Taylor                      | 30 yrs.            | Navy Yard Cemetery            |
| NO ? October 18  | Maren Johnson                            | 99 yrs. 2 m.       | Ivy Green Cemetery            |
| NO October 27    | Infant Stewart                           | infant             | Ivy Green Cemetery            |
| OK October 29    | <sup>SOUP ANNIE</sup><br>Louannie Turner | 29 y. 6 m. 27 d.   | Charleston Cemetery           |
| OK October 31    | John T. Hall                             | 46 y. 7 m. 16 d.   | Ivy Green Cemetery            |
| November 3       | Nellie A. Wilson                         | 57 y. 7 m. 15 d.   | ✓ Seabeck Cemetery            |
| November 20      | Lars Nelson                              | 55 yrs.            | ✓ Brownsville Cemetery        |
| October 31       | George E. Chrey                          | 20 y. 10 m. 27 d.  | Seattle, Washington           |
| NO November 25   | Infant Miller                            | infant             | Ivy Green Cemetery            |
| OK December 12   | Jacob Wedge                              | 73 y. 11 m.        | Charleston Cemetery           |
| OK December 12   | Charles Magill                           | 28 y. 3 m. 28 d.   | Ivy Green Cemetery            |
| December 14      | Charles Kuck                             | 40 yrs. 3 m.       | Seattle, Washington           |
| December 17      | Laverne Boyer                            | 18 y. 8 m. 13 d.   | ✓ Lake Bay Washington NO CARD |
| OK December 21   | <sup>HELEN</sup><br>Herden H. Valnagel   | 43 yrs. 7 m.       | Ivy Green Cemetery            |
| December 26      | Philomin Forcur                          | 66 y. 7 m. 12 d.   | Seattle, Washington           |
| December 29      | Martha Poulson                           | 2 yrs. 4 m. 6 d.   | Charleston Cemetery           |
| December 30      | Nellie A. Stanley                        | 40 y. 5 m. 23 d.   | Los Angeles, California       |
| OK about Dec. 30 | George Boggs                             | 63 yrs.            | Ivy Green Cemetery            |

1917

|               |                     |                      |                          |
|---------------|---------------------|----------------------|--------------------------|
| OK January 6  | Adelbert Warren     | 62 y. 11 m. 29 d.    | Ivy Green Cemetery       |
| OK January 9  | Mary Pearl Ronn     | 19 yrs. 7 m. 21 d.   | Charleston Cemetery      |
| NO January 10 | Helen Gurasima      | 12 days              | Ivy Green Cemetery       |
| OK January 14 | Mary Fahey          | 64 yrs.              | Ivy Green Cemetery       |
| January 24    | Charles Edward Ditt | 57 y. 5 m. 16d.      | Seattle, Washington      |
| OK January 25 | Sylvia E. Wade      | 20 y. 6 m. 28 d.     | Charleston Cemetery      |
| January 31    | Frances C. Bresman  | 3 yrs. 11 m. 14 d.   | Seattle, Washington      |
| February 19   | John P. Riddell     | 82 yrs. 6 m. 27 d. ✓ | Tracyton Cemetery        |
| February 19   | Mary Brown          | 39 y. 10 m. 26 d.    | Seattle, Washington      |
| February 19   | Ruben NawBuskirk    | 83 y. 11 m. 14 d.    | North Yakima, Washington |



LEWIS FUNERAL CHAPEL BURIALS continued

1917

|   |                                     |                    |                           |
|---|-------------------------------------|--------------------|---------------------------|
| OK February 20  | Elizabeth Sensit <sup>SENSIT</sup>  | 56 y. 3 m. 26 d.   | Ivy Green Cemetery        |
| OK February 22  | Myron J. Holt                       | 45 y. 6 m. 0 d.    | Ivy Green Cemetery        |
| NO February 27  | Pauline Fluder                      | Infant             | Ivy Green Cemetery        |
| OK March 2  | Jonathan Milt                       | 81 y. 11 m. 2 d.   | Ivy Green Cemetery        |
| Following entry was a disinterment on March 20, 1917, date of death is copied as entered on record, year of death must be incorrectly recorded. |                                     |                    |                           |
| October 19, 1917  | Leroy E. Turner                     | 27 yrs.            | Seattle, Washington       |
| March 22  | John Doyle                          | 76 yrs.            | Port Orchard, Washington  |
| OK March 30   | James Fox                           | 39 yrs.            | Ivy Green Cemetery        |
| OK April 4  | Jennie Lehwhoff <sup>LEHWHOFF</sup> | 61 y. 10 m. 17 d.  | Ivy Green Cemetery        |
| April 6   | Eliza Watson                        | 79 y. 11 m. 18 d.  | Los Angeles, California   |
| OK April 10   | George H. Geizit <sup>GEIZIT</sup>  | 66 y. 0 m. 15 d.   | Charleston Cemetery       |
| OK April 24   | John William Milt                   | 19 y. 5 m. 11 d.   | Ivy Green Cemetery        |
| April 26  | Julia Anderson                      | 27 yrs.            | Vancouver, Washington     |
| May 1   | Peter Erie                          | 55 y. 3 m. 18 d.   | Seattle, Washington       |
| NO May 24   | William Tate Jones                  | 31 y. 9 m. 6 d.    | Ivy Green Cemetery        |
| OK May 26   | Ruth L. Spaith <sup>SPAITH</sup>    | 6 y. 1 m. 2 d.     | Ivy Green Cemetery        |
| NO May 30   | Edward Inaby                        | 25 y. 7 m. 27 d.   | Ellensburg, Washington    |
| OK June 3   | Hilda Peterson                      | 3 y. 2 m. 16 d.    | Ivy Green Cemetery        |
| June 7  | Kenneth Heron                       | 34 yrs.            | San Francisco, California |
| June 12   | Georgia K. Thuman                   | 51 y. 8 m. 1 d.    | Seattle, Washington       |
| OK June 13  | Adolf Oyen                          | 62 y. 8 m. 10 d.   | Ivy Green Cemetery        |
| OK June 13  | Mary F. Smith                       | 52 yrs. 5 m. 10 d. | Charleston Cemetery       |
| OK June 4   | Thur B. Thursen                     | 56 y. 10 m. 16 d.  | Ivy Green Cemetery        |
| June 13   | Charles Henry Ast                   | 22 y. 5 m. 12 d.   | Oregon City, Oregon       |
| OK June 18  | Abben J. Campbell <sup>ABBY</sup>   | 78 yrs.            | Ivy Green Cemetery        |
| June 24   | Eddie G. Peterson                   | 24 y. 0 m. 1 d.    | Clifton, Texas            |
| June 25   | Hollis Franklin Hovey               | 21 y. 11 m. 18 d.  | Missoula, Montana         |
| NO June 27  | Louis Younger                       | 55 yrs.            | Charleston Cemetery       |
| July 1  | Myrtle J. Jaques                    | 26 y. 7 m. 13 d.   | Stanwood, Washington      |
| OK July 1   | Christina Mizner                    | 65 y. 11 m. 17 d.  | Charleston Cemetery       |
| July 1  | John Thomas                         | Child              | Seattle, Washington       |
| July 1  | Martin A. Medicis                   | 27 y. 11 m. 6 d.   | Opelousas, La.            |
| July 5  | William H. Trumbo                   | 21 y. 2 m. 15 d.   | Huston, Texas             |
| July 5  | Helen E. Trahey                     | 53 y. 11 m. 7 d.   | Ivy Green Cemetery        |
| July 5  | Charles Lund                        | 23 y. 8 m. 12 d.   | Seattle, Washington       |



MEMBERS' SURNAMES  
by Mrs. Nadine Rowan

Only one-fourth of our membership has turned in his (her) pedigree-ancestor charts. Will the other three-fourths please do so as soon as possible?

In our last issue, Vol. II, No. 2, an error was made in Mrs. Beverly Greene's surnames. Please change her CHRISTLER to CRISTLER. We apologize for the mistake and ask that if others are seen to please bring it to either my attention or the editor's Roseann Mitchell. Thank you!

Mrs. Addie M. (Larson) Gee, 2510 - 19th Street, Bremerton, WA 98310:

|                        |                              |
|------------------------|------------------------------|
| ALICE -                | KATNER -                     |
| BROWN -                | LARSON - Wn., Sweden         |
| BUGHER - Okla., Kan.   | PALBITSKA - Wn.              |
| CRAIG -                | SVENSON - Wn., Minn., Norway |
| GARTHE - Wn., Norway   | TUNMORE - Mich.              |
| GEE - Okla., Wn., Kan. | WALKER - Wn.                 |

Mrs. Margaret (Smith) Lentz, 2141 Cloward Way, Bremerton, WA 98310:

|                             |                        |
|-----------------------------|------------------------|
| BARRON - Mich, Ill, Ireland | ROCKWOOD - Wisc, Wn.   |
| CLARK -                     | SALTER -               |
| CLOSE - N.Y.                | SHEVLAND - Wn., Norway |
| KNUDSON - Wn., Norway       | SMITH - Mich, Canada   |
| O'BRIEN -                   | THOMAS -               |
| RASSMUSEN -                 | TONNESON - Norway      |

Mrs. Sharon (Raney) Streitt, 4410 E Street, Bremerton, WA 98310:

|                                |                        |
|--------------------------------|------------------------|
| BURGESS - Ark.                 | MOORE -                |
| CASTELL - Ark, Ill.            | MORRIS - Ala, Ark.     |
| DICKERSON - Tenn.              | MOSURE - Mo, Ark.      |
| DUNN - Ark, Tenn.              | PATRIDGE - Tenn.       |
| HANDY - Ill.                   | RANEY - Ore, Ark, Tex. |
| HOBSON - Ark, Tenn, Ore, Miss. | SHIPMAN -              |
| McBRIDE -                      |                        |

Mr. Charles L. Rennick, 3514 Rocky Point, Bremerton, WA 98310:

|                             |                                 |
|-----------------------------|---------------------------------|
| BEAR - N.Y.                 | PLUMB -                         |
| COYNE -                     | RATHFAN -                       |
| DAWSON - Ill, Wisc, England | RENNICK - Wisc, Ariz, Ireland   |
| GARRITT -                   | ROBERTS - England               |
| GRAVES -                    | RUSSELL - Wisc, N.Y, Conn, Ill, |
| HALE/HALES/HAILS - Wisc.    | Pa, Mass, England               |
| HOLMES -                    | SMITH - England                 |
| JEWELL - Ill, England.      | STEELE - Ill.                   |
| KILBURN -                   | TERRY -                         |
| MOYER - Pa.                 | WOODRUFF - Conn.                |
|                             | WOODWARD - Mass.                |

Mrs. Nadine (Thurston) Rowan, 1543 N. Cambrian, Bremerton, WA 98310:

|                        |                                 |
|------------------------|---------------------------------|
| ANDERSON - Cal, Norway | MASTERSON - Ind, Mo, Ohio, Cal. |
| BURT - N.Y.            | PONDER - Md.                    |
| BUTCHER - Ohio, Md.    | THURSTON - Cal, N.Y.            |
| HUNSDOD - Norway       |                                 |
| LINGALEIN - Norway     |                                 |



Mrs. Janice (Peterson) Richardson, 5884 Rimrick Dr. NE, Bremerton:  
 CARLSDOTTER - OLOFSDOTTER -  
 FONAAS - Wisc, Alaska, Norway PETERSDOTTER - Smaland  
 GROTING - PETERSON - Minn, Wn, Sweden  
 GUSTAVSDOTTER - Algutsboda PETTERSON - Sweden  
 HAGE - Wisc, Norway ROGNES -  
 HALSTENS DATTER - RONNINGEN - Norway  
 JONASDOTTER - Lindehult ROTTUM -  
 JONASSON - Algutsbuda SOKNES - Norway  
 JONSON - Sillemaa SVENSDATTER - Norway  
 KROGSTAD - Norway SVENSSON - Sweden  
 MANSSON - WIBERG -  
 NILSSON - Sweden

Mrs. Ida (Weatherholt) Tevault, Rt. 6, Box 6338, Poulsbo, WA 98370:  
 BROWN - OWENS - Ind.  
 CAMERON - Ind. SHRODE - Ind.  
 FRANK - Ind. SIM -  
 ICE - Ind. SMALL - Ind.  
 KINCAID - STATELER -  
 McCOY - Ind. WEATHERHOLT - Ind.

Mr. Richard Tevault, Rt. 6, Box 6338, Poulsbo, WA 98370:  
 ARBUTHNOT - McWILLIAMS -  
 CALLIS - Ind, England MARTIN - Ind.  
 CHRISTMAS - Ind., Ky. RALSTON -  
 CUNNINGHAM - RICHARDSON - Ind.  
 HOPKINS - Ind. TEVAULT - Ind.  
 HUNT - WHYE - Ind., England  
 JENKINS - WOOLDRIDGE -  
 JOHNSON -

Mr. Paul R. Rowan, 1543 N. Cambrian, Bremerton, WA 98310:  
 BAKER - Del. PUNTENNEY - Ohio, Pa, Ky.  
 BARTINDALE - Ind, N.Y. Canada ROWAN - Nev, Ind, Ida, Ohio, Md.  
 COUMBE - England SOUTHWORTH - Ohio, Ind.  
 HENRY - Pa. SYLVESTER - N.J.  
 KING - Ohio, Ind, Va. WILES - Ind, Ohio, Md, Pa.  
 PIXLEY - Ohio

Mrs. Catherine (Bly) Sullivan, Rt. 4, Box 2476, Bremerton, WA 98310:  
 BLY - Neb, Ids, Ill, N.Y., NOLAN - Wa, England  
 Conn, England RATHBUN -  
 CLARK - Ohio RYAN - Ireland  
 DIETRICK - SPREADBOROUGH - Eng, Wales  
 DONOVAN - Neb, Ireland SULLIVAN - Mont, Ireland  
 HARRINGTON - TANNER - Ill.  
 KLATOWSKI - WARMINSKI - Wn, Poland, Germany  
 KNOOF - W. Prussia WILLIAMS - Wales  
 McNULTY - Ireland ZACKRICH - Wn, W. Prussia  
 MOKOSKI - Minn.  
 MORROW - Wn, N.D, S.D, Vermont,  
 Ireland